

www.aquafilter.com

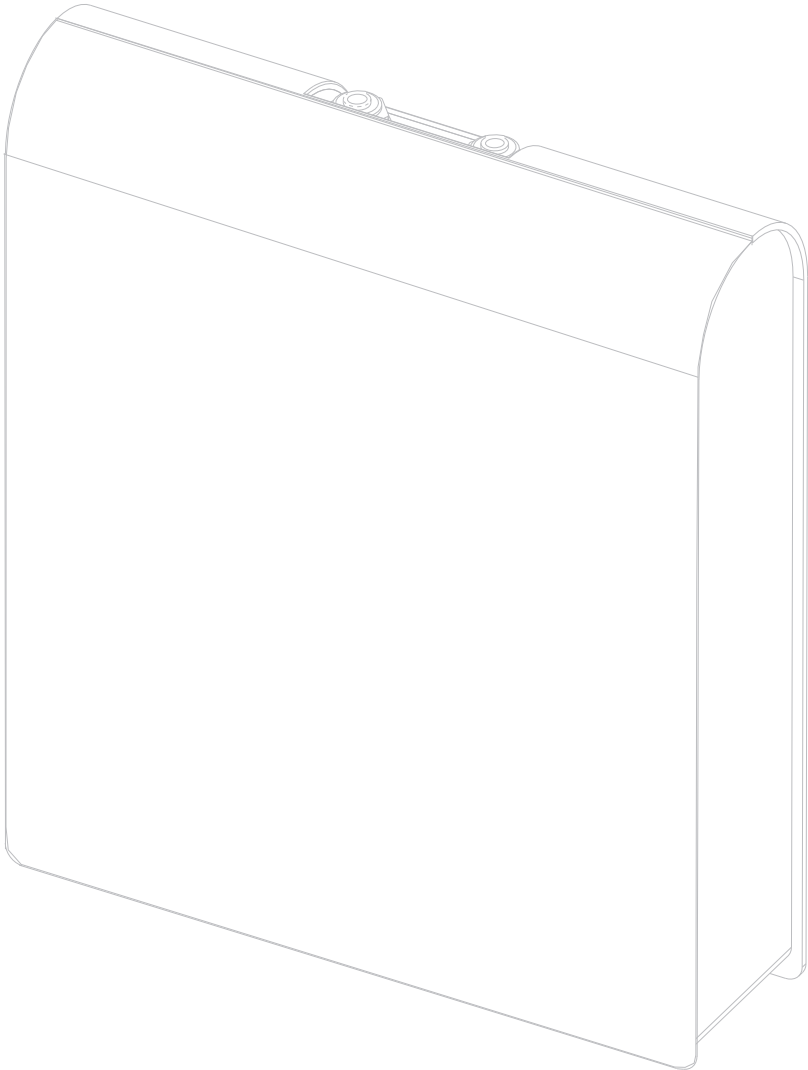

The Clear Choice
Water Filtration Systems



Installation Manual

1. Safety Precautions

WARNING! The system should not be used with biologically contaminated water or water of unknown origin.

Product may be installed only by trained service professionals. Only original replacement parts, filter cartridges and accessories made by manufacturer may be used.

Compliance with the following instructions ensures:
 - problem-free product operation,
 - manufacturer's warranty.

Failure to comply with the following instructions will result in loss of warranty.

- 1) Read carefully this Instruction Manual before beginning system installation.
- 2) Check if all elements needed for the installation are included with the system. (refer to point 3 "Included in the Box").
- 3) Please note that after installing the system, as well as after each filter cartridge and UF membrane replacements, and in the case of long inactivity of the system, system flushing procedure must be conducted before resuming system usage.
- 4) After inserting a tubing into a quick connector or a quick connector onto a stub the connected plice should be secured with a safety clip.
- 5) During disconnecting and connecting of tubing be sure not to break it (correctly installed tubing should be inserted 1.5 cm inside of quick connector).
- 6) After connection tubing with quick connector insert safety clip to secure the connection.
- 7) For sealing plastic components use only Teflon tape!
- 8) Wash your hands thoroughly before and after filter cartridge or membrane element replacements.
- 9) During the cartridge or capillary membrane installation one must consider water flow direction. An arrow put on each of our inline cartridges indicates water flow direction.
- 10) In all cases of product returns, the system must be returned in its original packaging – otherwise the return will not be accepted.
- 11) The EXCITO-ST needs to be protected against high pressure build-ups by installing one of the pressure regulators: PLV-0104-80 or PLV-0104-50 in case EXCITO-ST is equipped with UF membrane (capillary membrane).
- 12) Manufacturer is not responsible for any damages resulted from the use of this product if used for other purposes than filtration of potable water.
- 13) Manufacturer does not hold any responsibility for printing errors.
- 14) Manufacturer reserves the right to introduce change or amendments to the provided technical informations at any time and without the necessity of a prior announcement.







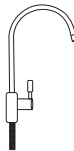

Use only genuine Aquafilter® filter cartridges. In case of using other brands products, the manufacturer is responsible for ineffective performance of the system.

2. Technical Specifications

Inlet water temperature.....	between 2°C and 45°C
Water supply pressure.....	6 bar
Water supply adapter.....	1/2"
Outlet tubing.....	1/4"
Dimensions (height x width x depth).....	438 mm x 100 mm x 360 mm

IMPORTANT! In order to ensure proper operation of the system, the installation of pressure regulator is necessary. In case of system EXCITO-ST use pressure regulators PLV-0104-80 (5.3 bars – 80 psi – not included with the system set) or PLV-0104-50 (3.3 bars – 50 psi – not included with the system set) in case EXCITO-ST is equipped with capillary membrane TLCHF-FP or TLCHF-2T. The regulator protects the system against unexpected pressure increases and against high water pressure hammers. Systems without proper regulators loose their product warranty.

3. Included in the Box

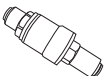
 Water filtration System EXCITO	 Chrome filter faucet FXFCH17-C	 Chrome-plated adapter FT06* (1/2" MIP x 1/2" FIP x 1/4" FIP)	 Chrome-plated adapter FT07 (3/4" MIP x 3/4" FIP x 1/4" FIP)	 Chrome-plated adapter FT02 (3/4" MIP x 3/4" FIP)
brak w zestawie - dodatkowe wyposażenie.				
 Teflon tape TAS0003*	 Shut-off valve SEWBV1414*	 Flexible tubing KTPE14W*	 Installation manual XI-EXCITO	 Pressure regulator PLV-0104-80 PLV-0104-50 (not included with the system set)

4. Connection Scheme for EXCITO-ST

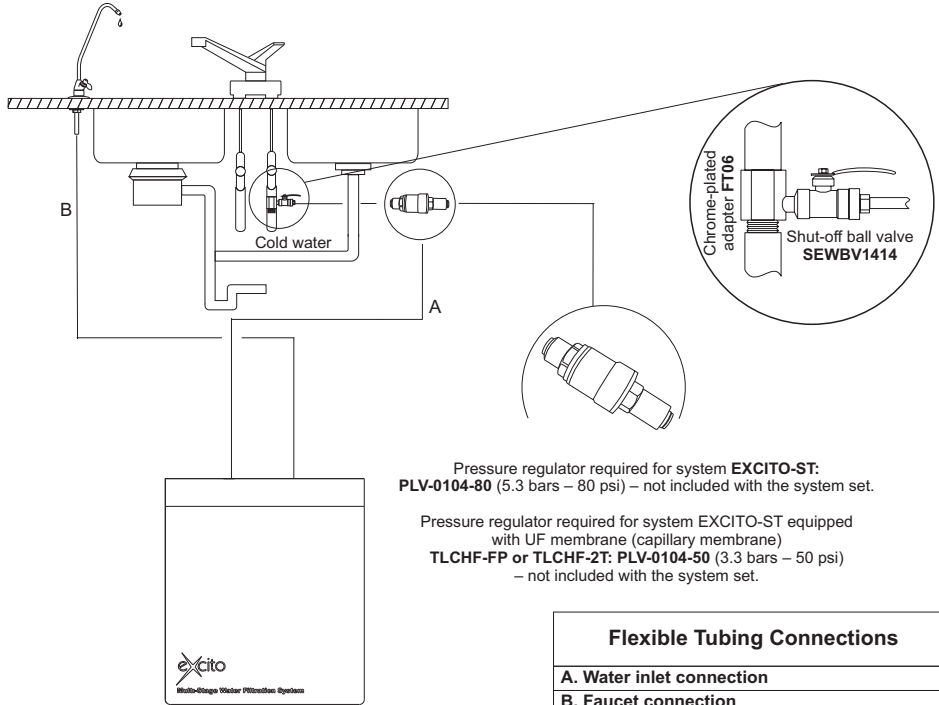

5. Connecting Flexible Tubing with Quick Connectors: Type JG (John Guest) and QC (Quick Connector)

Disconnecting Flexible Tubing:

- 1) Remove safety clips from quick connector (Fig. 1).
- 2) Press on the flange of quick connector (Fig. 2).
- 3) Pull out flexible tubing (Fig. 3).

Connecting Flexible Tubing:

- 1) Insert flexible tubing 1.5 cm (0.6 in) deep into the quick connector (Fig. 4).
- 2) Insert safety clip (Fig. 5).

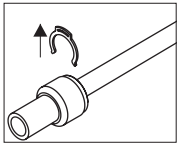

Fig. 1

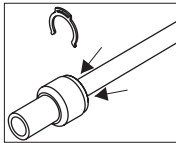

Fig. 2

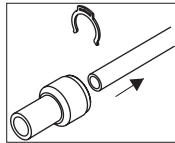

Fig. 3

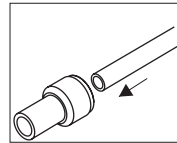

Fig. 4

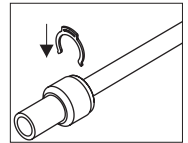

Fig. 5

5.1. Removing and Installing the Elbow in Quick Connector

Removing elbow from cartridge:

- 1) Remove safety clip from quick connector (Fig. 1).
- 2) Press on the flange of quick connector and remove the elbow (Fig. 2).

Installing the elbow into cartridge:

- 1) Insert the elbow into quick connector to the point of resistance (Fig. 3).
- 2) Insert safety clip (Fig. 4).

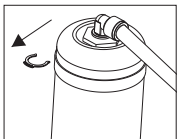

Fig. 1

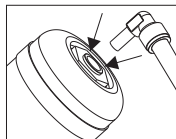

Fig. 2

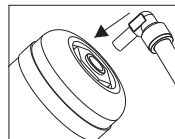

Fig. 3

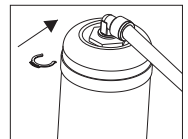

Fig. 4

5.2. Instructions for connecting and disconnecting filter cartridge and elbow connector (new filter cartridge with elbow connector)

Disconnecting elbow connector from filter cartridge:

- 1) Remove safety clips from quick connector (fig.1).
- 2) Push quick connector's flange symmetrically and pull the tubing out (fig. 2).
- 3) Unscrew inlet and outlet connectors from old filter cartridge (fig.3)
- 4) Remove old Teflon tape (fig.4).
- 5) Apply multiply layers of new Teflon tape (ensure that Teflon tape is winded in the opposite direction to the direction connector will be installed) (fig. 5).

Connecting elbow connector with filter cartridge:

- 1) Screw the elbow connector back to new filter cartridge.

NOTE! Do NOT remove elbow connector after the installation has been started. Stopping and removing (unscrewing) the element may result in inadequate connection and water leak. (fig.6).

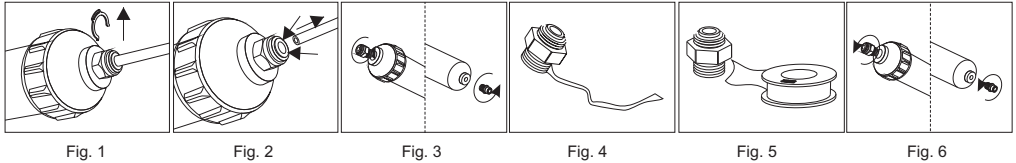

6. System Installation - Stage I

IMPORTANT NOTE! Manufacturer is not responsible for any damages that result from improper installation or use of system. System installation should be performed only in temperatures above 2°C (35.6°F).

IMPORTANT NOTE: Before installing the system, remove from the filter housing all components necessary for installation.

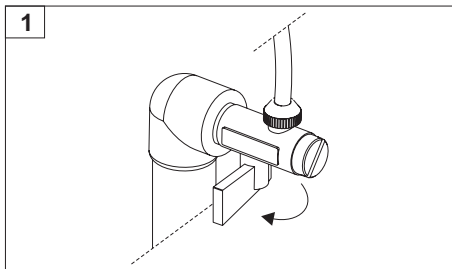

Shut off cold water supply valve.

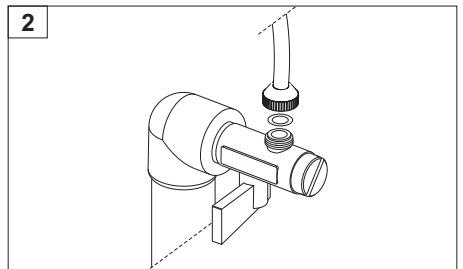

Unscrew flexible tubing from the shut-off valve (the adapter). **IMPORTANT NOTE! Between the shut-off valve and flexible tubing is a rubber gasket - be sure not to lose it.**

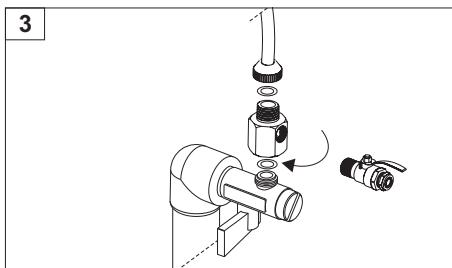

Screw chrome-plated adapter onto the shut-off valve to allow easy installation of **SEWBV1414** valve and its easy opening and closing.

IMPORTANT NOTE! Remember to place rubber gaskets in between the connections.

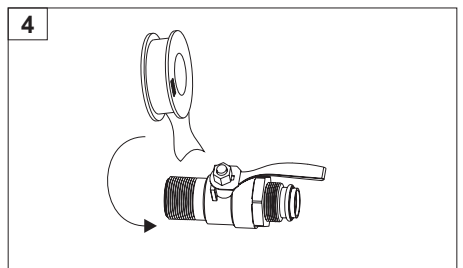

Wind a few layers of Teflon Tape (**TAS0003**) on shut-off valve adapter (**SEWBV1414**).

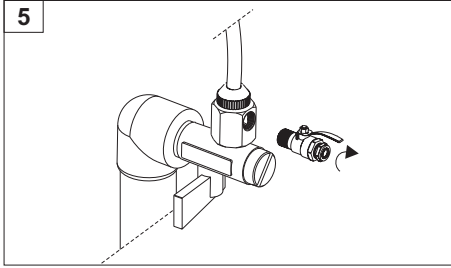

Screw **SEWBV1414** valve into chrome-plated adapter **FT06**.

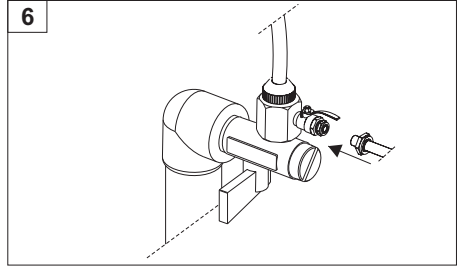

Place the nut on flexible tubing and connect it with **SEWBV1414** valve. Next, push the tubing all the way into the valve and tighten the nut.

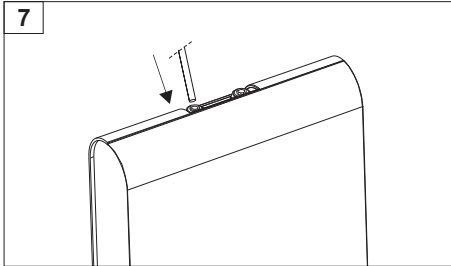

Connect flexible tubing of **SEWBV1414** valve with system's water inlet [IN] (red ring).

6.1 System Installation - Wall Faucet Connection

IMPORTANT NOTE! Manufacturer is not responsible for any damages that result from improper installation or use of system. System installation should be performed only in temperatures above 2°C (35.6°F).

IMPORTANT NOTE: Before installing the system, remove from the filter housing all components necessary for installation.

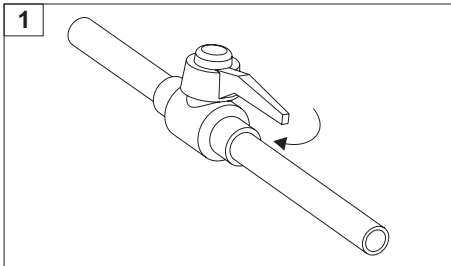

Shut off water supply valve.

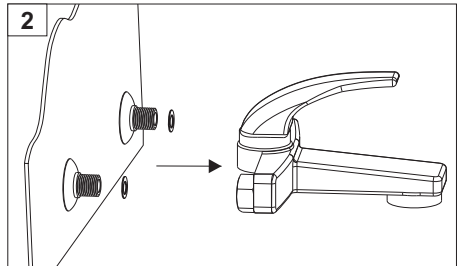

Unscrew the faucet from the wall.

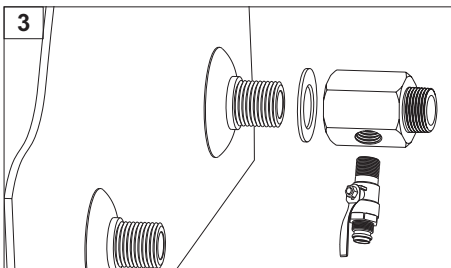

Screw chrome-plated adapter **FT07** onto the cold water pipe to allow easy installation of **SEWBV1414** valve and its easy opening and closing.

IMPORTANT NOTE! Remember to place rubber gaskets in between the connections.

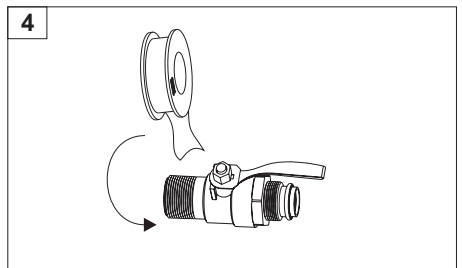

Wind a few layers of Teflon Tape **TAS0003** on shut-off valve adapter **SEWBV 1414**.

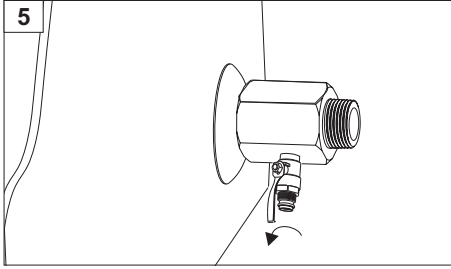

Screw **SEWBV1414** valve into chrome-plated adapter **FT07**.

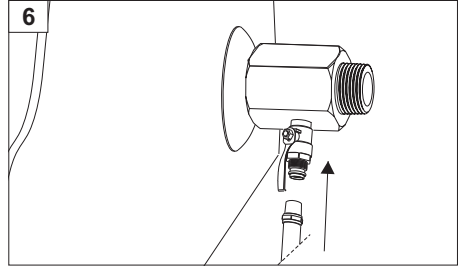

Place the nut on flexible tubing and connect it with **SEWBV1414** valve. Next, push the tubing all the way into the valve and tighten the nut.

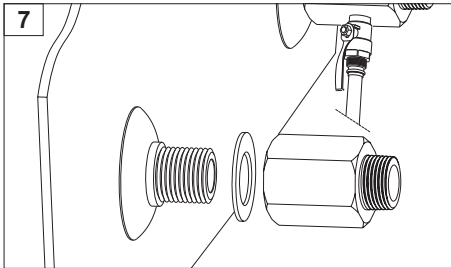

Screw chrome-plated adapter **FT02** onto the hot water pipe. **IMPORTANT NOTE! Remember to place rubber gaskets in between the connections.**

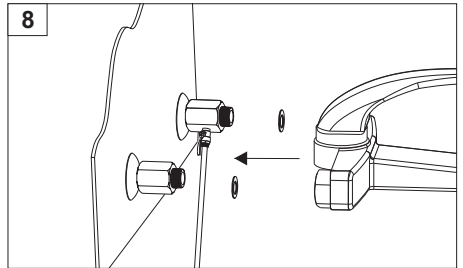

Screw the wall faucet to the installed adapters.

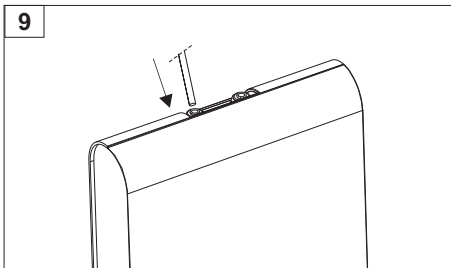

Connect flexible tubing of **SEWBV1414** valve with system's water inlet [IN] (red ring).

7. System Installation - Stage II - FXFCH5, FXFCH17-C Faucet Installation

- 1) Drill a 12 mm opening in a kitchen counter or kitchen sink (in case of enamel sinks, the manufacturer recommends drilling openings in the structure supporting sink).
- 2) On threaded faucet extension [1], first put on cover plate [2], and then rubber gasket [3].
- 3) Secure the faucet in the drilled sink/counter opening.
- 4) Underneath the sink, put the rubber [5] and metal [6] washers on the faucet extension [4], and tighten with metal nut [7].
- 5) Install flexible tubing (supplying water and connecting faucet with the system):
 - put the tubing [11] through the metal nut [10] and plastic tightening ring [9],
 - put the insert [8] into the tubing,
 - push flexible tubing (all the way) into the faucet extension [4] and tighten it (by hand!) with the metal nut [10].
- 6) Connect other end of flexible tubing with connector [OUT] (white ring) (Fig. 2).

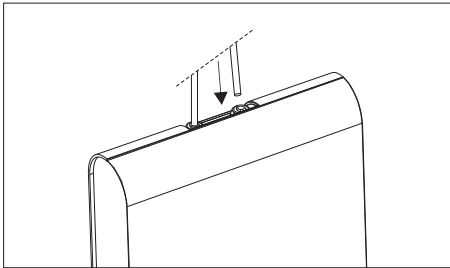

Fig. 2 Connecting flexible tubing with [OUT] connector

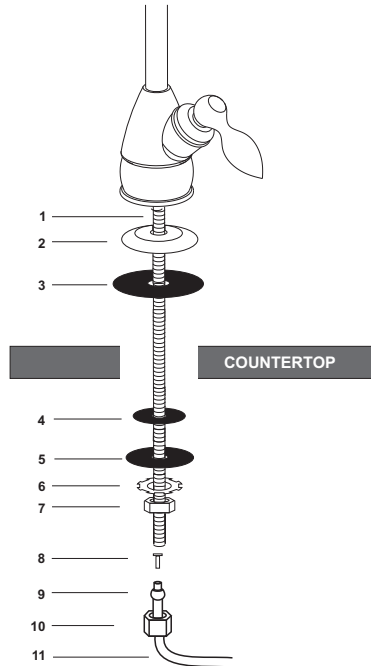
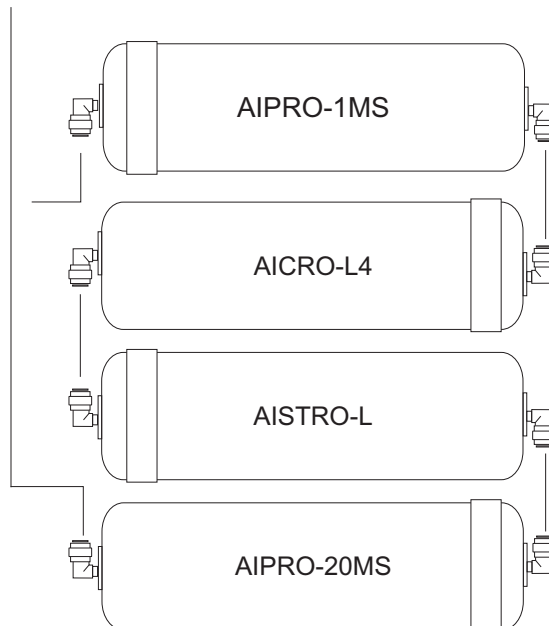

Fig. 1 Installing filter faucet on kitchen counter

8. Cartridge Connection Scheme in EXCITO-ST System

WATER SUPPLY INLET



8.1 Cartridge Connection Scheme (set EXCITO-CRT)

WATER SUPPLY INLET

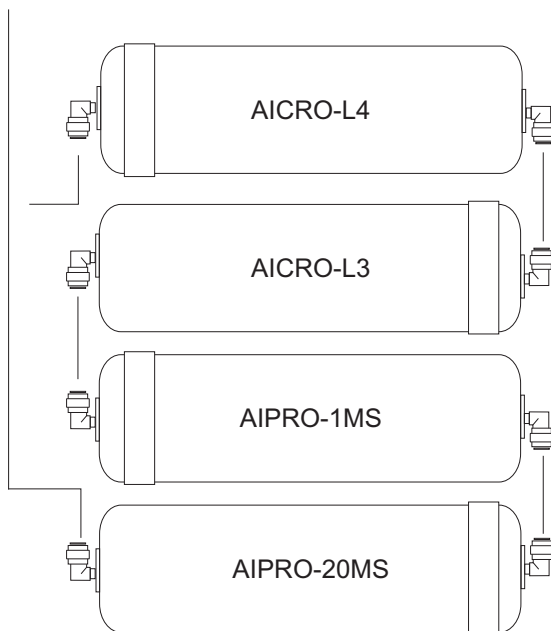

8.2 Cartridge Connection Scheme (set EXCITO-CLR-CRT)

WATER SUPPLY INLET

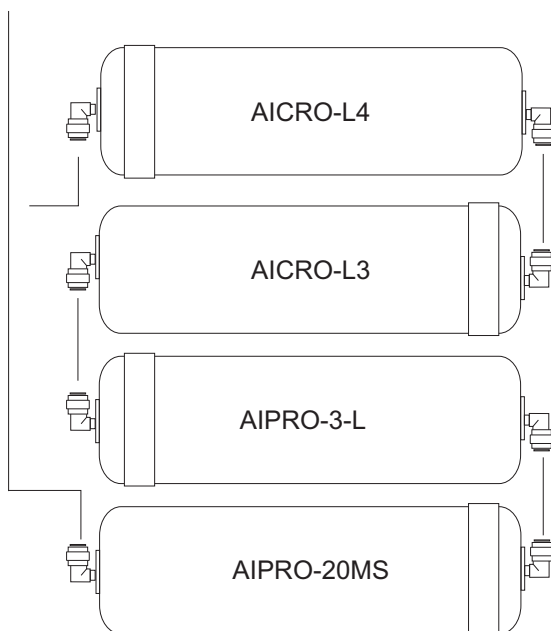

8.3 Cartridge Connection Scheme (set EXCITO-HF-CRT)

WATER SUPPLY INLET

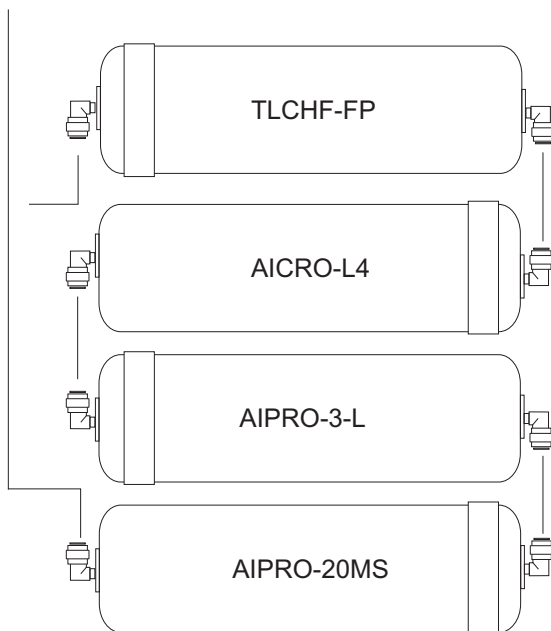







9. Cartridge Sets

Aquafilter® introduces four new filter cartridges sets for EXCITO-ST. Table below list available cartridges and their names.

NAME OF SET	EXCITO-ST-CRT	EXCITO-CRT	EXCITO-CLR-CRT	EXCITO-HF-CRT
CARTRIDGE 1	AIPRO-20MS	AIPRO-20MS	AIPRO-20MS	AIPRO-20MS
CARTRIDGE 2	AISTRO-L	AIPRO-1MS	AIPRO-3-L	AIPRO-3-L
CARTRIDGE 3	AICRO-L4	AICRO-L3	AICRO-L3	AICRO-L4
CARTRIDGE 4	AIPRO-1MS	AICRO-L4	AICRO-L4	TLCHF-FP*

* UF membrane is sold separately.

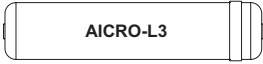
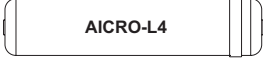
10. Replacement Cartridges

Cartridge Type	Description / Filtration Stages	Longevity*
		Months
 AIPRO-20MS	AIPRO-20MS Polypropylene cartridge removes sediments such as rust, sand and suspended solids.	3 - 6
 AIPRO-1MS	AIPRO-1MS Polypropylene cartridge removes sediments such as rust, sand and suspended solids.	3 - 6
 AIPRO-3-L	AIPRO-3-L Three layer cartridge: <ul style="list-style-type: none"> - Polypropylene foam - removes sand, rust and other suspended matters, - Conditioning media - removes iron and iron derivative compounds. - Ion exchange filtration media - acts as water softener, exchanges ions of calcium and magnesium into ions of sodium preventing scale build-up, 	3 - 6
 AISTRO-L	AISTRO-L In-line water softening filter cartridge, reduces water hardness.	3 - 6
 AICRO-L3	AICRO-L3 Granulated activated carbon cartridge made of the high grade activated coconut carbon. It is designed to remove up to 99% of chlorine, sediments and organic contaminants. It also improves the taste and aroma of water.	3 - 6
 AICRO-L4	AICRO-L4 Granulated activated carbon cartridge made of the high grade activated coconut carbon. It is designed to remove up to 99% of chlorine, sediments and organic contaminants. In addition, a special filtration media removes heavy metals such as lead, nickel, chromium and many others. It also improves the taste and aroma of water.	3 - 6
 TLCHF-FP	TLCHF-FP / TLCHF-2T UF membrane removes microscopic bacteria in size of 0.02 micron and larger.	6 - 12

*depends on water quality and level of contamination.

Before the first use and after each cartridge replacement procedure, the system should be flushed with 15 liters of water. Next, allow the system to standby for 5-6 hours to activate the filtration media. After these procedures, the water is ready for consumption.

IMPORTANT NOTE! Used cartridges may not be returned.

11. Filter cartridge replacement – General information

IMPORTANT NOTE! Before removing flexible tubing and elbow, remove safety clip and symmetrically push in the flange of quick connector. After installing flexible tubing and installing the elbow, remember to insert safety clip of the quick connector.

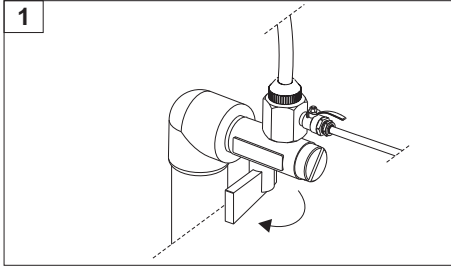

Shut off water supply valve.

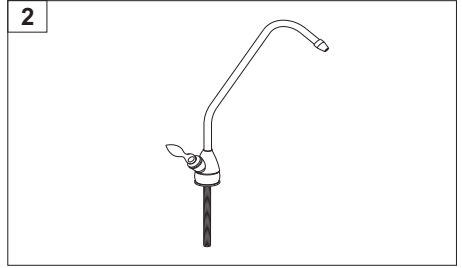

Open filter faucet to release pressure from the system.

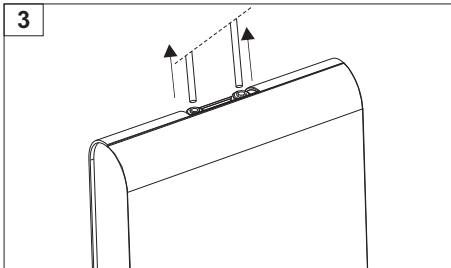

Before replacing the membrane, disconnect all flexible tubing from the system (inlet / outlet).

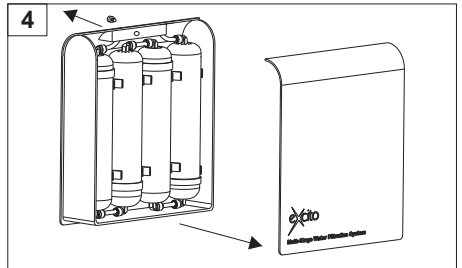

Unscrew the holding screw and remove front panel of the system's housing.

11.1. Filter cartridge replacement – System equipped with quick connect type cartridges

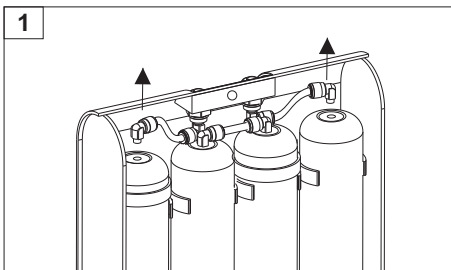

Remove the elbows: one from the water inlet of the first cartridge; one from the water outlet of the last cartridge. **IMPORTANT NOTE!** While removing the elbows, be careful not to bend flexible tubing.

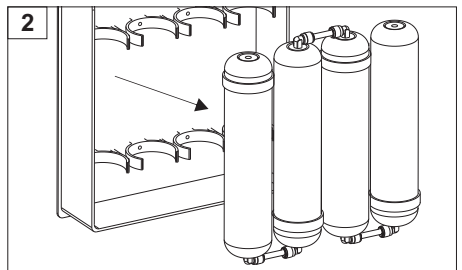

Unpin all cartridges together from the mounting clips.

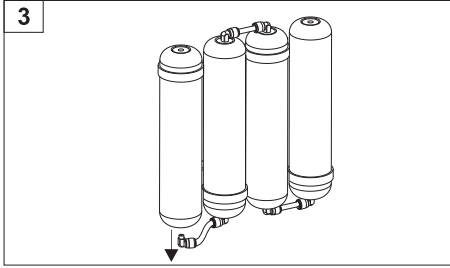

Remove elbow from used **AIPRO-20MS** cartridge and connect it with replacement cartridge **AIPRO-20MS**. Repeat this action to replace remaining cartridges.

IMPORTANT NOTE! During cartridge installation, remember to follow proper direction of water flow indicated by an arrow on cartridge label.

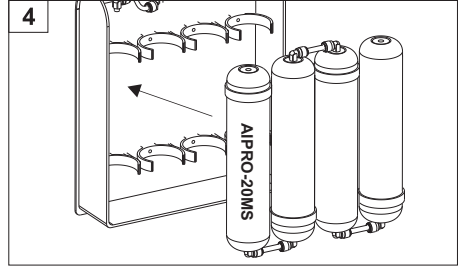

Insert all replaced cartridges into mounting clips of the system's housing. Make sure that **AIPRO-20MS** is first from the left.

IMPORTANT NOTE! During cartridge installation, remember to follow proper direction of water flow indicated by an arrow on cartridge label.

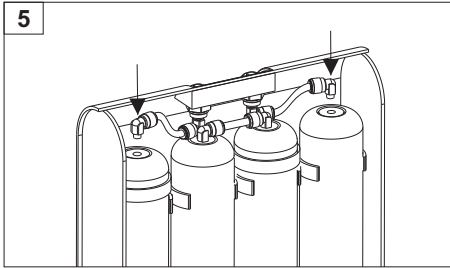

Connect the elbows: one with the water inlet of the first cartridge; one with the water outlet of the last cartridge.

IMPORTANT NOTE! Before the first use and after each cartridge replacement procedure, the system should be flushed with 15 liters of water. Next, allow the system to standby for 5 - 6 hours to activate the filtration media. After these procedures, the water is ready for consumption.

To replacement hollow fiber membrane follow the above described procedure.

11.2. Filter cartridge replacement – System equipped with cartridges with regular connectors

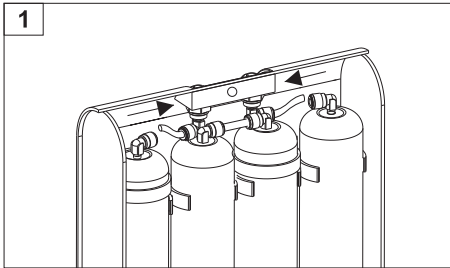

Disconnect tubing from elbow inlet connector attached to cartridge **AIPRO-20MS**.

Disconnect tubing from elbow outlet connector attached to cartridge **AICRO-L4**.

Proceed as follows:

- 1) remove safety clips
- 2) Symmetrically press quick connector's collar
- 3) Pull out the tubing

NOTE! Described procedure can be found on page 4, point 5.2.

NOTE! When pulling out the tubing, use caution to prevent the tubing from damage. Collapsing of the tubing may result in damage and future water leaks.

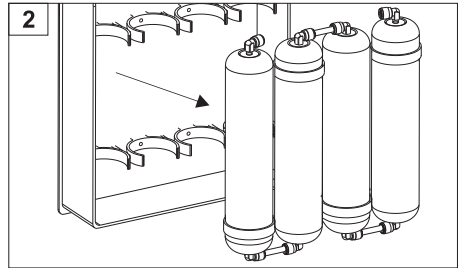

Remove all filter cartridges out of mounting clips and the system housing.

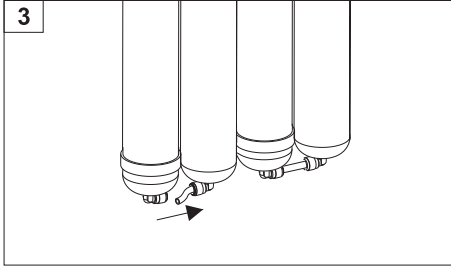

Disconnect tubing from elbow outlet connected to cartridge **AIPRO-20MS**.

Proceed as follows:

- 1) Remove safety clips
- 2) Symmetrically press quick connector's collar
- 3) Pull out the tubing

NOTE! Described procedure can be found on page 4, point 5.2.

NOTE! When pulling out the tubing, use caution to prevent the tubing from damage. Collapsing of the tubing may result in damage and future water leaks.

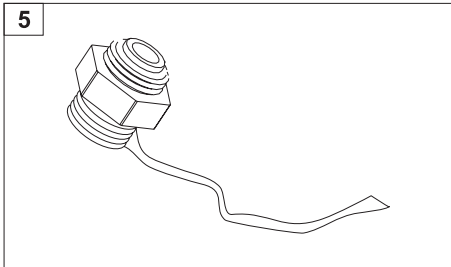

Remove old Teflon tape out of the connectors thread surface.

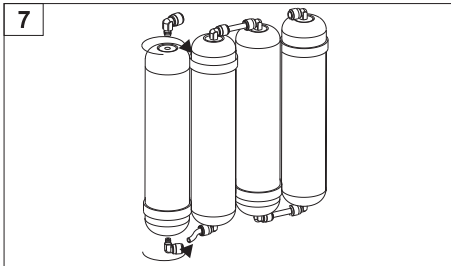

Install (screw in) connectors into new filter cartridge.

NOTE! During installing (screwing in) individual connectors do NOT withdraw (unscrew) them at any time. This may result in connection damage and future water leaks.

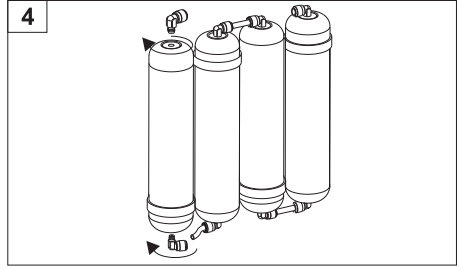

Unscrew inlet and outlet connectors from **AIPRO-20MS** filter housing.

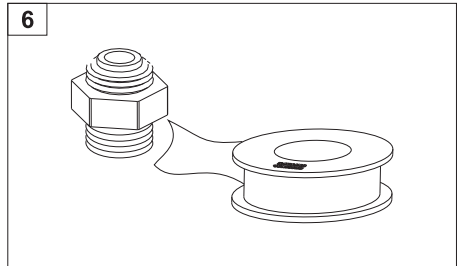

Apply several layers of Teflon tape to the connectors threads.

NOTE! Use only Teflon tape, do not use tow.

NOTE! Apply Teflon tape in the opposite direction to the direction connectors will be installed.

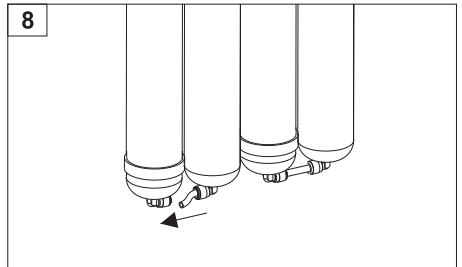

Connect tubing with elbow outlet connector attached to **AIPRO-20MS** filter cartridge.

Proceed as follows:

- 1) Ensure that new filter cartridge is placed in accordance with the direction of system's water flow.
- 2) Insert tubing into outlet elbow connector attached to cartridge **AIPRO-20MS** (correctly inserted tubing is mounted 1.5 cm deep inside elbow connector).
- 3) Secure the connection with safety clip.

NOTE! Described procedure can be found on page 4, point 5.2.

NOTE! When pulling out the tubing, use caution to prevent the tubing from damage. Collapsing of the tubing may result in damage and future water leaks.

In order to complete installation of the remaining replacement cartridges, repeat the procedures described in points 1-8.

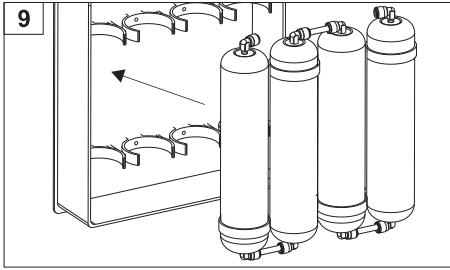

Place filter cartridge into mounting clips. Install **AIPRO-20MS** in such way that the cartridge is placed on left side of the filtration system.

NOTE! During the installation, remember about maintaining correct water flow direction - water flow direction is indicated on a label placed on each replacement cartridge.

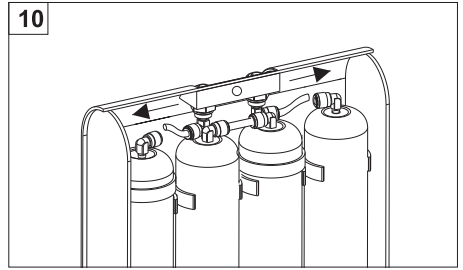

Connect tubing with elbow outlet connector attached to cartridge **AIPRO-20MS**.
Connect tubing with elbow outlet connector attached to **AIPRO-L4** filter cartridge.

Proceed as follows:

- 1) Ensure that filter cartridge is placed in accordance with the direction of system's water flow. Correct direction of water flow is indicated on a label placed on each replacement cartridge.
- 2) Insert tubing into outlet elbow connector attached to cartridge **AIPRO-20MS** (correctly inserted tubing is mounted 1.5 cm deep inside elbow connector)
- 3) Secure the connection with safety clip.

NOTE! When pulling out the tubing, use caution to prevent the tubing from damage. Collapsing of the tubing may result in damage and future water leaks.

IMPORTANT NOTE! Before the first use and after each cartridge replacement procedure, the system should be flushed with 15 liters of water. Next, allow the system to standby for 5 - 6 hours to activate the filtration media. After these procedures, the water is ready for consumption.

To replacement UF membrane follow the above described procedure.

11.3. Filter cartridge replacement – General information

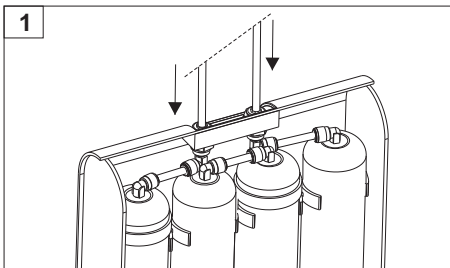

Examine all connections carefully. Before replacing the front panel, connect flexible tubing to the system (inlet / outlet).

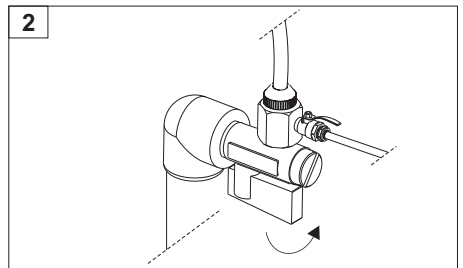

With filter faucet in a closed position, slowly open water supply valve and check for leaks.

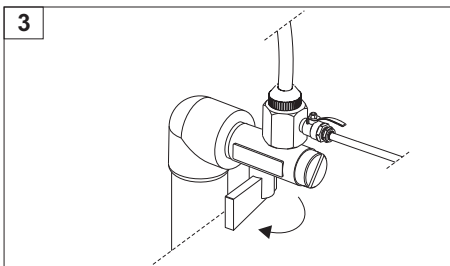

14 Shut off water supply valve.

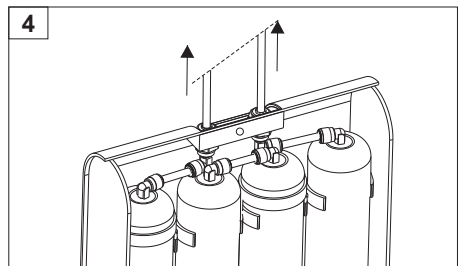

Disconnect flexible tubing from the system.

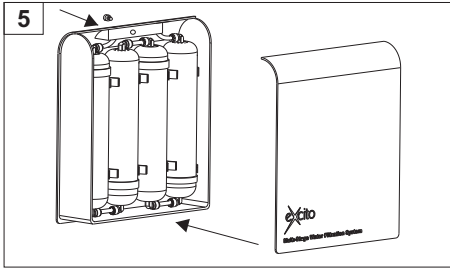

Replace the front panel and screw it with the housing.

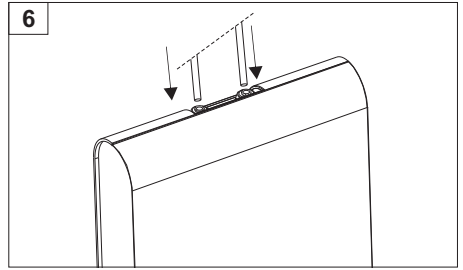

Connect flexible tubing to the system (inlet / outlet).

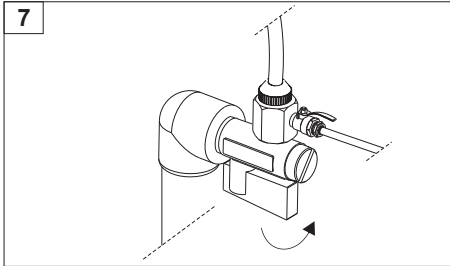

With filter faucet in an open position, slowly open water supply valve.

IMPORTANT NOTE! Before the first use and after each cartridge replacement procedure, the system should be flushed with 15 liters of water. Next, allow the system to standby for 5 - 6 hours to activate the filtration media. After these procedures, the water is ready for consumption.

12. Filter cartridge replacement – EXCITO-ST system

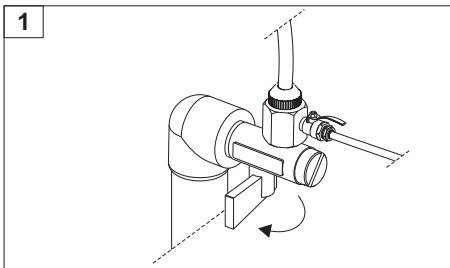

Shut off water supply valve.

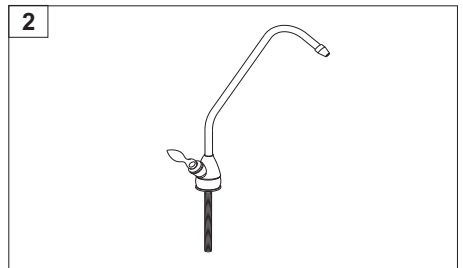

Open filter faucet to release pressure from the system.

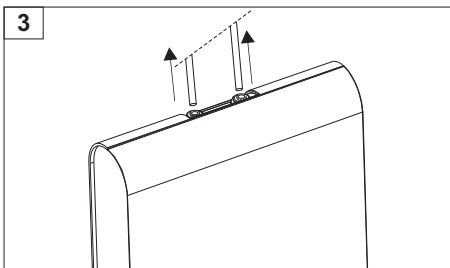

Before replacing the membrane, disconnect all flexible tubing from the system (inlet / outlet).

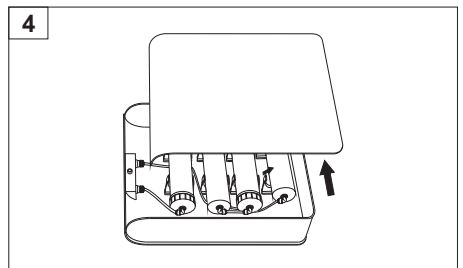

Remove front panel of the system's housing.

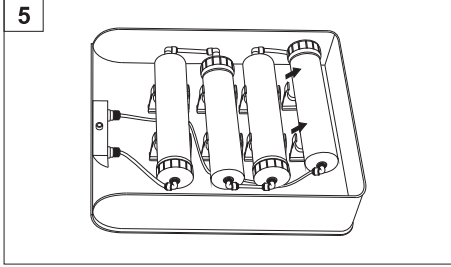

Remove filter cartridge **AIPRO-20MS** from mountain brackets.

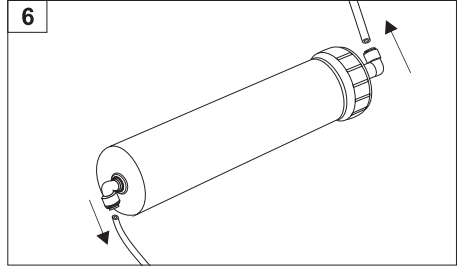

Disconnecting tubing from the inlet elbows of filter cartridge **AIPRO-20MS**.

Do the following:

- 1) Detach the safety clips from elbow inlet and outlet of the cartridge.
- 2) Press the elbow flange symmetrically.
- 3) Pull the tubing out.

NOTE! The procedure has been described in point. 5.1 on page 4.

NOTE! When removing tubing be particularly careful not to bend it. The collapse of the tubing can lead to breakage and water leakage.

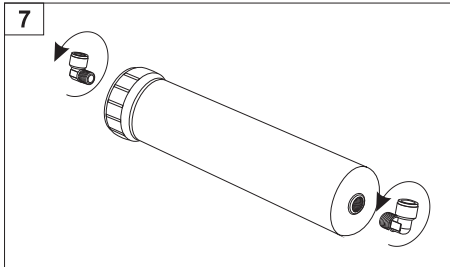

Unscrew inlet and outlet connectors from **AIPRO-20MS** filter housing.

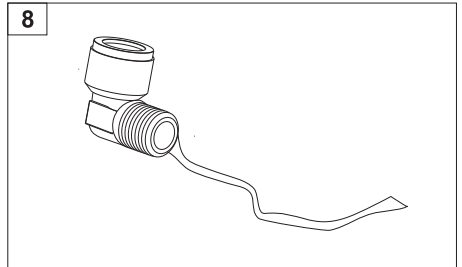

Remove old Teflon tape out of the connectors thread surface.

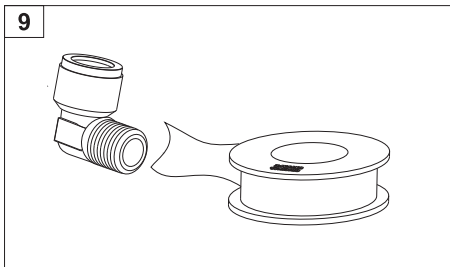

Apply several layers of Teflon tape to the connectors threads.

NOTE! Use only Teflon tape, do not use tow.

NOTE! Apply Teflon tape in the opposite direction to the direction connectors will be installed.

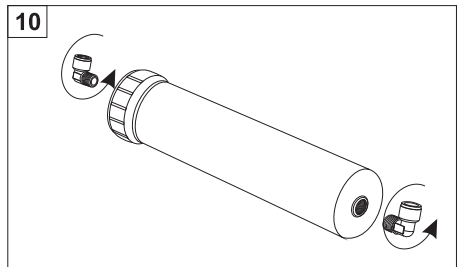

Install (screw in) connectors into new filter cartridge.

NOTE! During installing (screwing in) individual connectors do NOT withdraw (unscrew) them at any time. This may result in connection damage and future water leaks.

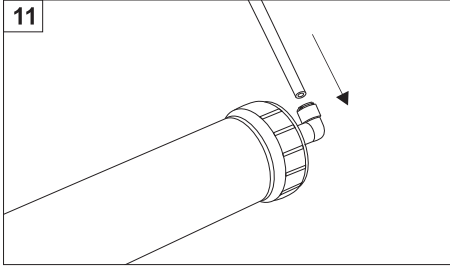

Connecting outlet elbow from filter cartridge **AIPRO-20MS** with inlet elbow of filter cartridge **AISTRO-L** using flexible tubing.

Do the following:

- 1) Make sure that the input will be connected in the direction of water flow. The correct water flow direction is indicated by arrows placed on the label of each filter cartridge.
- 2) Push-in tubing into the output elbows attached to filter cartridge **AIPRO-20MS** (properly inserted tubing sets in about 1.5 cm).
- 3) Secure the connection with safety clip.

NOTE! The procedure have been described in point. 5.1 on page 3.

NOTE! When inserting the tubing be particularly careful not to bend it. The collapse of the tubing can lead to breakage and water leakage.

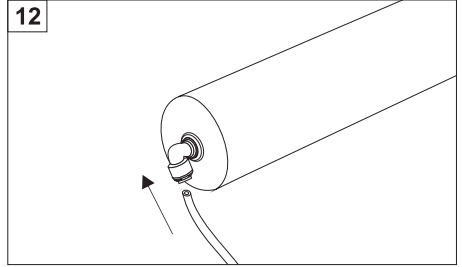

Connecting input elbow from filter cartridge **AIPRO-20MS** with water supply using tubing.

Do the following:

- 1) Make sure that the filter cartridge is installed correctly in the same direction as water flow. Water flow direction is marked with arrow on the product label.
- 2) Push the inlet tubing into the elbow connector, attached to the **AIPRO-20MS** filter cartridges (properly inserted tubing sets in about 1.5 cm.)
- 3) Secure the connection with safety clip.

NOTE! The procedure have been described in point. 5.1 on page 3.

NOTE! When inserting the tubing be particularly careful not to bend it. The collapse of the tubing can lead to breakage and water leak.

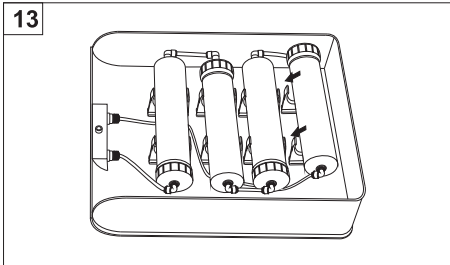

Insert filter cartridge into mounting brackets.

To replace the renaming filter cartridges follow instruction described by points 5 - 13.

After the installation of new filter cartridges, conduct system test to ensure that there are no water leaks – follow instructions described in point 11.3.

NOTE! After each replacement cartridge, you must pass 15 liters of water through the system. After completing the above-mentioned procedures, filter water can be consumed.